

CHECK VALVES BALL TYPE

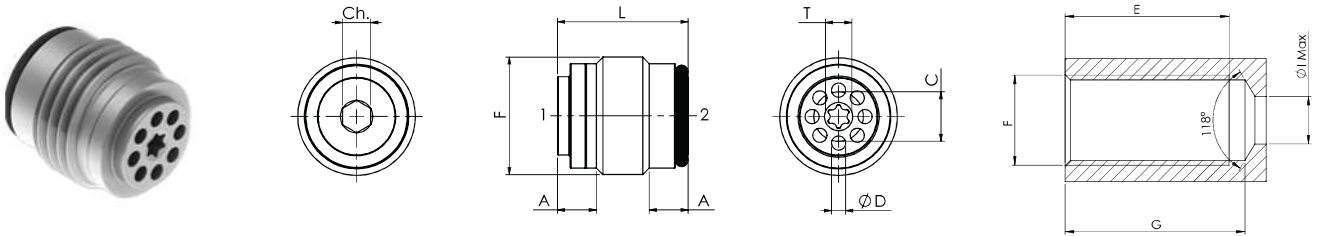

It's possible to install the valve in both directions

TECHNICAL CHARACTERISTICS

mm [Inches]

F	L	A	C	D	E	G	I	Ch.	T	O-RING
1/4 BSPP	17 [0,67]	5,5 [0,22]	6 [0,24]	1,3 [0,05]	28 [1,10]	31 [1,22]	7 [0,28]	3	Torx T15	9 x 1
3/8 BSPP	18,5 [0,73]		7,5 [0,30]	2 [0,08]	31 [1,2]	34 [1,34]	9 [0,35]	4	Torx T15	10,82 x 1,78
1/2 BSPP	22,5 [0,88]	7 [0,28]	10 [0,39]	2,5 [0,1]	35 [1,38]	38 [1,5]	12 [0,47]	6	5	14 x 1,78

HYDRAULIC CIRCUIT



PERFORMANCES

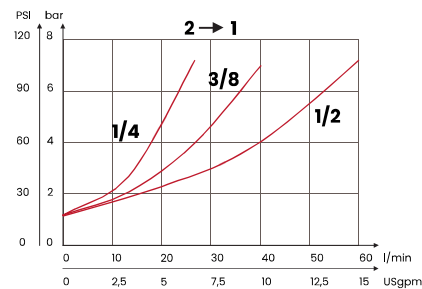

ORDERING CODE

ORDERING CODE	F	MAX FLOW l/min USgpm	MAX PRESSURE bar PSI	TIGHTENING TORQUE Nm lbt ft	WEIGHT kg lbt
VUS1B	1/4 BSPP	20 [5,3]	350 [5075]	4 [3,5]	0,01 [0,022]
VUS2B	3/8 BSPP	30 [7,9]		6 [5,3]	0,018 [0,040]
VUS3B	1/2 BSPP	50 [13,2]		10 [8,8]	0,033 [0,073]

Mineral oil: DIN 51524 ISO 6743/4 | Oil viscosity: 15 to 250 cSt 15-250 mm²/s | Oil temperature: -4°F + 176°F -20°C +80°C | Ambient temperature: -4°F + 122°F -20°C +50°C | Max contamination index with filter: 5 to 250 cSt 15-250 mm²/s | It is necessary a filter use to protect the valve (advised filtration 15 µm) | Max leakage: 0,25 cm³/min - 5 drops/min | Cracking pressure: 0,5 bar 7,25 PSI